

**DEVELOPMENT APPLICATIONS**

**DARWIN**

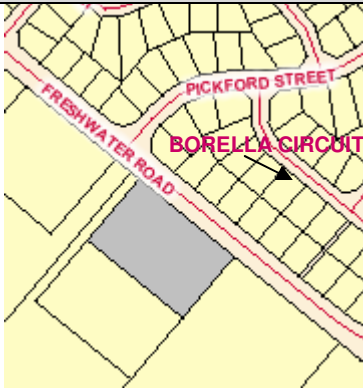

Lot 9738, Town of Nightcliff  
47 Freshwater Road, Jingili  
Subdivision to create 2 lots  
Earl James and Associates

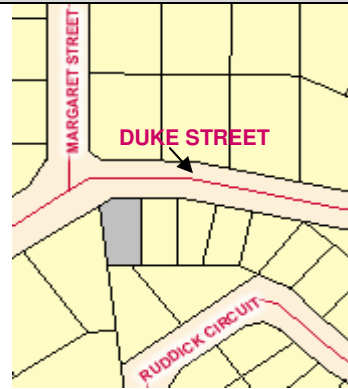

Lot 7731, Town of Darwin  
14 Duke Street, Stuart Park  
3 storey single dwelling exceeding 8.5 metres in  
height with a reduced side setback  
Paul William Baxter



Lot 565, Town of Nightcliff  
76 Nightcliff Road, Rapid Creek  
Verandah addition to an existing 2 storey single  
dwelling with a reduced front setback  
Benjamin Sanders

**DARWIN**

**PALMERSTON**

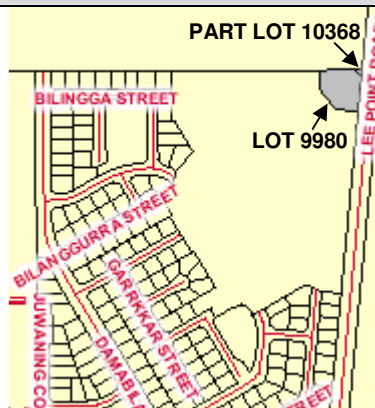

Lot 9980 and Part lot 10368, Town of Nightcliff  
Lee Point Road, Lyons  
4 single dwellings with reduced front setbacks  
Elton Consulting

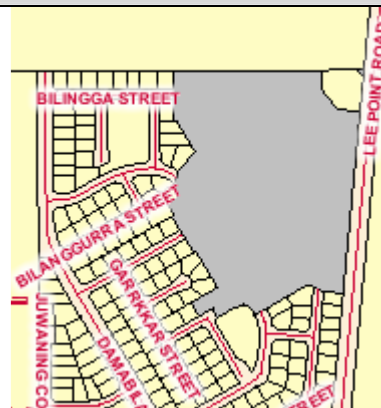

Lot 10368, Town of Nightcliff  
Lee Point Road, Lyons  
95 single dwellings with reduced front setbacks  
(Lyons- Stages 11A, 11B, 12A, 12B&12C)  
Elton Consulting

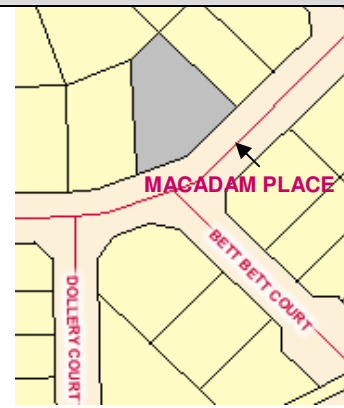

Lot 7544, Town of Palmerston  
6 Macadam Place, Gunn  
Variation to front setback for a shade sail addition  
to a single dwelling  
David James

**CLOSING DATE FOR SUBMISSIONS FRIDAY 14 AUGUST 2009 - 4:00PM CST**

Applications may be inspected at Development Assessment Services, 38 Cavenagh Street, Darwin, the relevant council office and Palmerston City Library (Palmerston applications only).

Submissions must be lodged by the closing date indicated in order to be considered by the consent authority. Submissions in relation to an application must be in writing and include the name and postal address of the author and may be made publicly available in full.

Submissions may be lodged with Development Assessment Services, Department of Planning and Infrastructure, GPO Box 1680, Darwin NT 0801, hand-delivered to the ground floor, 38 Cavenagh Street, Darwin or emailed to [das.dpi@nt.gov.au](mailto:das.dpi@nt.gov.au).

For enquiries phone: 8999 8966 or fax: 8999 6055.

Web site: [www.nt.gov.au/planning](http://www.nt.gov.au/planning)