

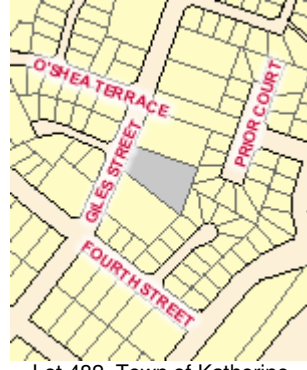

APPLICATIONS LODGED FOR ASSESSMENT UNDER THE *PLANNING ACT* DEVELOPMENT APPLICATIONS



N.T. Portion 5626
Stuart Highway, Cossack
Radio telescope, Global
Navigational Satellite System
antenna and base station
Department of Planning
& Infrastructure



Lot 482, Town of Katherine
25 Giles Street, Katherine
Sobering-Up Shelter within
defined flood area
Department of Health
& Families



Lot 136, Town of Katherine
12 Fourth Street, Katherine
Shop within defined flood area
Nordraft

CLOSING DATE FOR SUBMISSIONS WEDNESDAY 8 JULY 2009 - 4:00PM CST

Applications may be inspected at Development Assessment Services, 5 First Street Katherine or at the Katherine Town Council Office.

Submissions must be lodged by the closing date indicated in order to be considered by the consent authority. Submissions in relation to an application must be in writing and include the name and postal address of the author and may be made publicly available in full.

Submissions may be lodged with Development Assessment Services, Department of Planning and Infrastructure, GPO Box 1680, Darwin NT 0801, GPO Box 1171, Katherine NT 0851 or hand-delivered to the ground floor, 38 Cavenagh Street, Darwin, 5 First St, Katherine or emailed to das.dpi@nt.gov.au.

For enquiries phone: 8999 8966 or fax: 8999 6055.

Web site: www.nt.gov.au/planning

DEPARTMENT OF PLANNING AND INFRASTRUCTURE