

# APPLICATIONS LODGED FOR ASSESSMENT UNDER THE *PLANNING ACT*

## DEVELOPMENT APPLICATIONS

### DARWIN

### EAST ARM

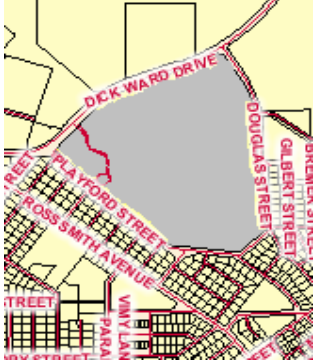

Lot 5298, Town of Darwin  
20 Dick Ward Drive, Fannie Bay  
Marquee addition to existing horse racing facility for the purpose of a function room  
Darwin Turf Club

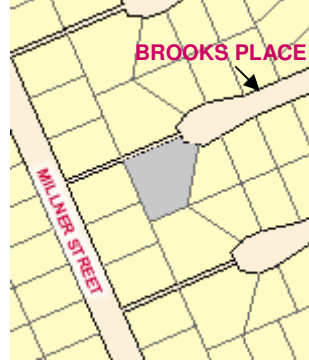

Lot 1252, Town of Nightcliff  
6 Brooks Place, Millner  
4 x 2 bedroom multiple dwellings in 2 single storey buildings  
Troppo Architects (NT)

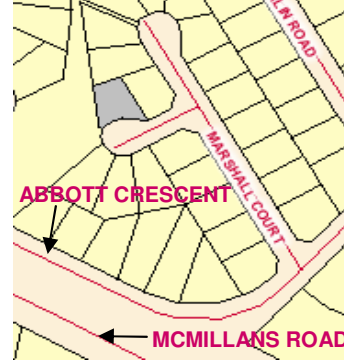

Lot 2414, Town of Sanderson  
10 Marshall Court, Malak  
2 x 2 bedroom multiple dwellings in a single storey building  
Troppo Architects (NT)

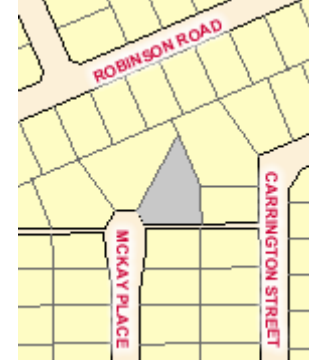

Lot 1535, Town of Nightcliff  
10 McKay Place, Millner  
4 x 2 bedroom multiple dwellings in 2 single storey buildings  
Troppo Architects (NT)

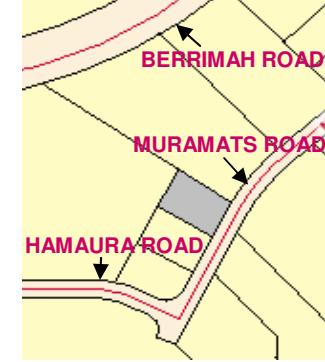

Section 4745, Hundred of Bagot  
28 Muramats Road, East Arm  
Change in use to showroom sales with associated servicing activities  
Aggreko Generator Rentals Pty Ltd

### PALMERSTON

### LITCHFIELD

### OTHER AREAS

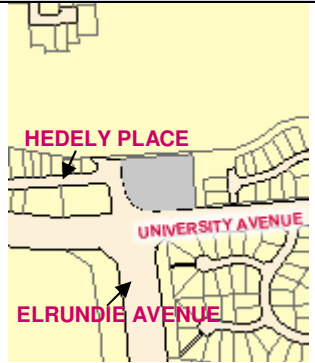

Lot 6389, Town of Palmerston  
130 University Avenue, Durack  
Shop additions  
Spectator Investments



Lot 9265, Town of Palmerston  
43 McAulay Street, Rosebery  
4 x 2 bedroom multiple dwellings in 2 single storey buildings  
PSC Development



Section 2675, Hundred of Strangways  
34 Kensington Road, Girroraween  
Demountable structure  
Brett Niddrie



Sections 5125 & 5126,  
Hundred of Bagot  
2 & 4 Mander Road, Holtze  
Display village for transportable housing  
Group 1 Consulting

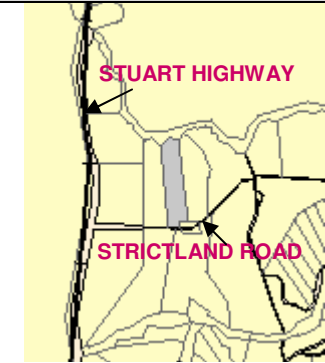

Section 131, Hundred of Playford  
143 Strickland Road, Adelaide River  
Clearing of native vegetation  
Maneroo Cattle Co Pty Ltd

## CLOSING DATE FOR SUBMISSIONS FRIDAY 9 OCTOBER 2009 - 4:00PM CST

Applications may be inspected at Development Assessment Services, 38 Cavenagh Street, Darwin and the relevant council office.

Submissions must be lodged by the closing date indicated in order to be considered by the consent authority. Submissions in relation to an application must be in writing and include the name and postal address of the author and may be made publicly available in full.

Submissions may be lodged with Development Assessment Services, Department of Planning and Infrastructure, GPO Box 1680, Darwin NT 0801, hand-delivered to the ground floor, 38 Cavenagh Street, Darwin or emailed to [das.dpi@nt.gov.au](mailto:das.dpi@nt.gov.au).

For enquiries phone: 8999 8966 or fax: 8999 6055.

Web site: [www.nt.gov.au/planning](http://www.nt.gov.au/planning)

DEPARTMENT OF PLANNING AND INFRASTRUCTURE