

NT Por
3869

ELLIOTT BUILDING AREA (BBELL 001)

GURUNGU
ELLIOTT NORTH CAMP

**GURUNGU
ABORIGINAL LAND TRUST**

NT Por 3720

Newcastle Waters
NT Por 2093

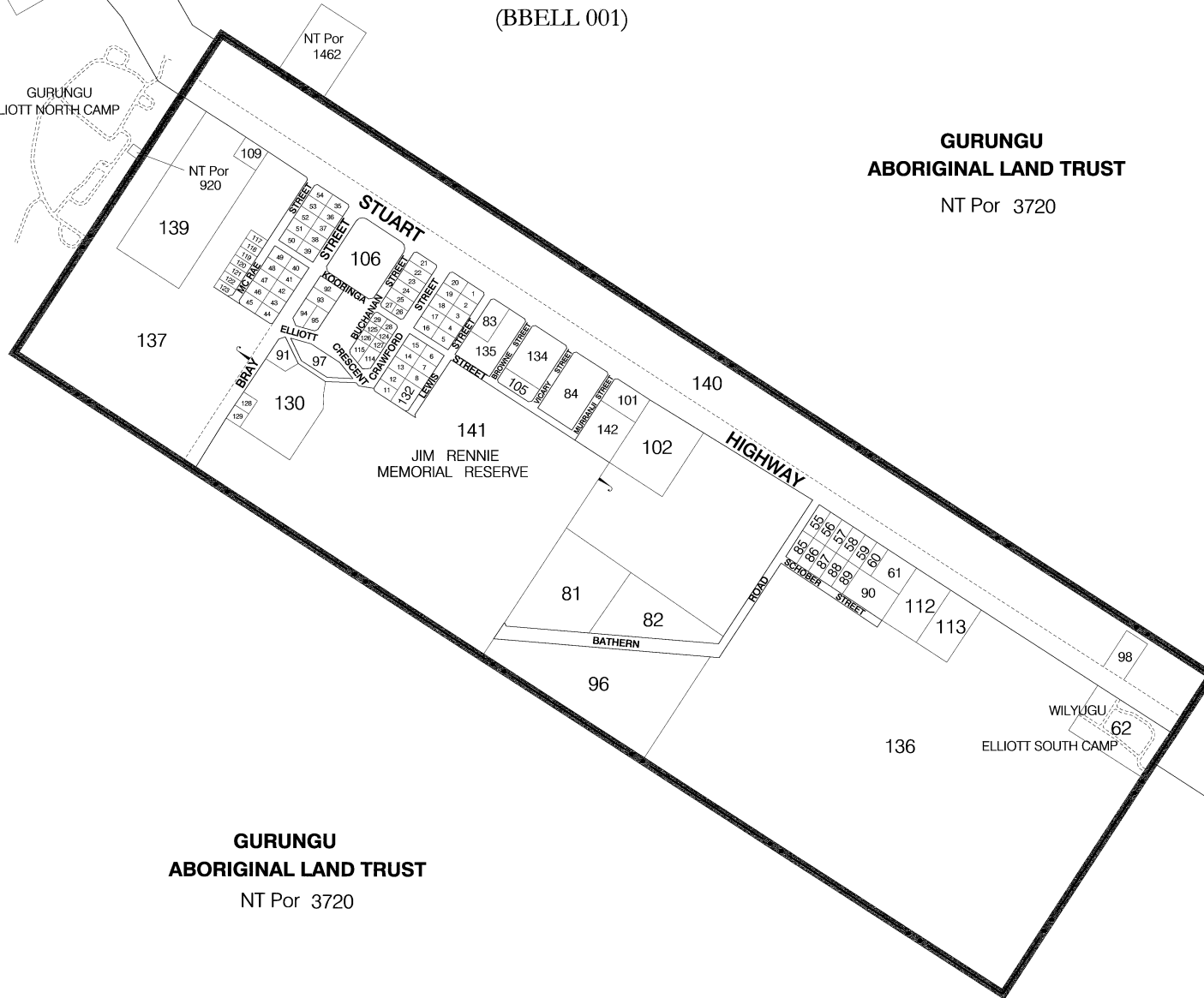

**GURUNGU
ABORIGINAL LAND TRUST**
NT Por 3720

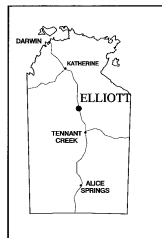

GDA
Zone 53

Town Boundary ——— • • ———
Northern Territory Government Gazette No. G34, 23 August 1950
Northern Territory Government Gazette No. G50, 20 December 1989

Building Area Boundary —————

The Northern Territory of Australia does not warrant that the product or any part of it is correct or complete and will not be liable for any loss, damage or injury suffered by any person as a result of its inaccuracy or incompleteness. You are encouraged to notify any error or omission in the material by calling 0899 7566.

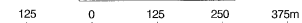

Northern Territory Government
Department of Infrastructure, Planning and Environment



CP4960

[Signature]
Minister for Lands and Planning
Date: 10/9/04

Cadastral Current as at 29/01/2004 Source: Northern Territory DCDB