

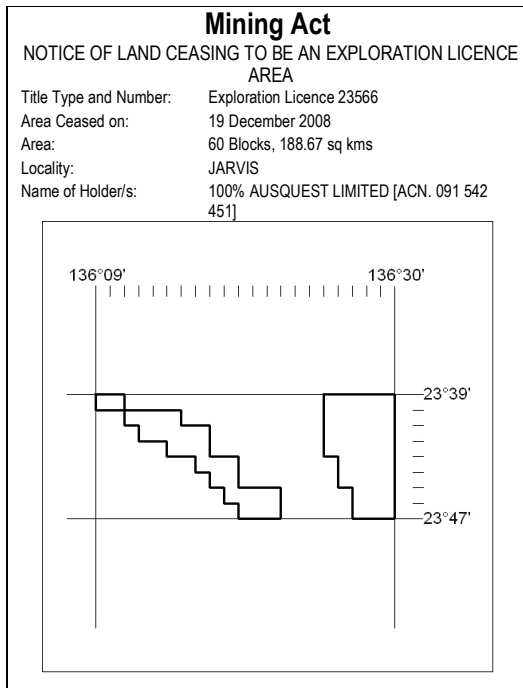

MN05/09

DARWIN

04 February 2009



33/09

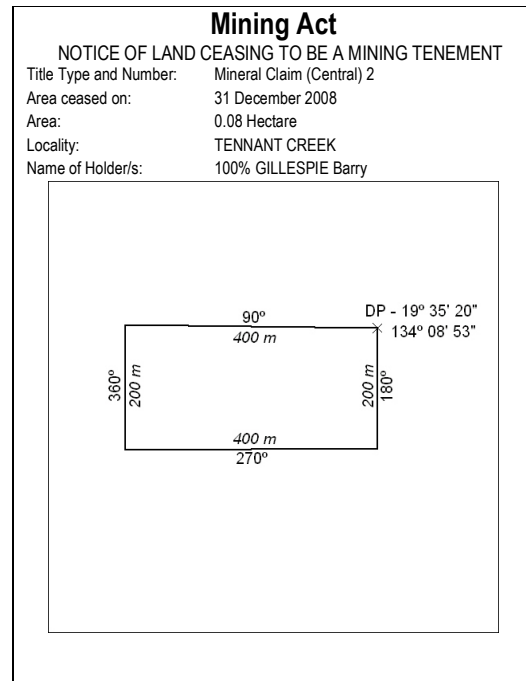

35/09

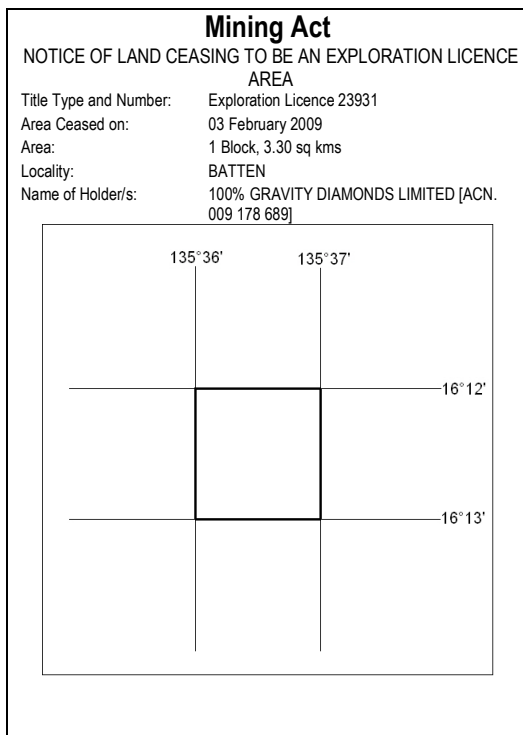

34/09

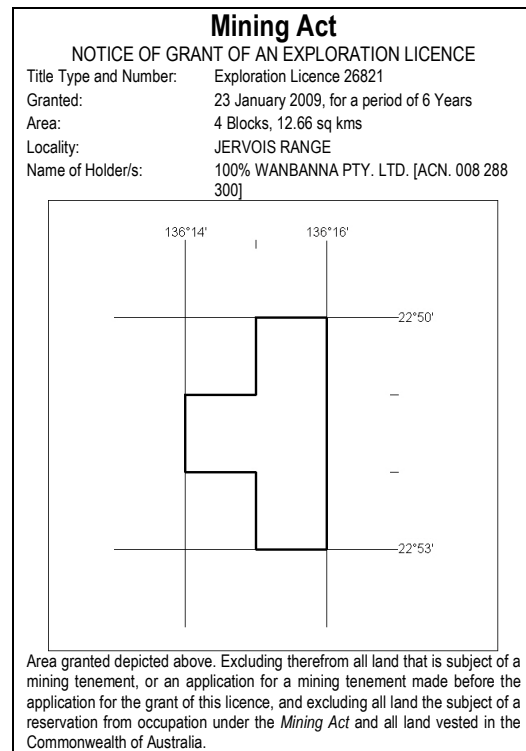

36/09



MN05/09

DARWIN

04 February 2009

Mining Act

NOTICE OF GRANT OF A MINING TENEMENT

Title Type and Number: Extractive Mineral Permit 23894
 Granted: 23 December 2008, for a period of 2 Years
 Area: 97.00 Hectares
 Locality: NOONAMAH
 Name of Holder/s: 100% A AND SF MADDALOZZO PTY. LIMITED [ACN. 009 624 015]

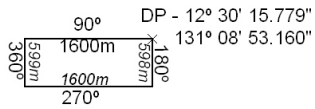

37/09

Mining Act

NOTICE OF GRANT OF A MINING TENEMENT

Title Type and Number: Extractive Mineral Permit 26720
 Granted: 09 January 2009, for a period of 2 Years
 Area: 4.00 Hectares
 Locality: ALICE SPRINGS
 Name of Holder/s: 100% DANN Garry

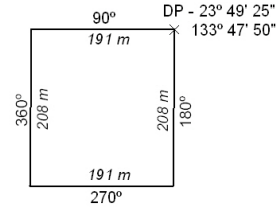

39/09

Mining Act

NOTICE OF GRANT OF A MINING TENEMENT

Title Type and Number: Extractive Mineral Permit 26044
 Granted: 06 January 2009, for a period of 2 Years
 Area: 13.00 Hectares
 Locality: KOOLPINYAH
 Name of Holder/s: 100% HANSON CONSTRUCTION MATERIALS PTY LTD [ACN. 009 679 734]

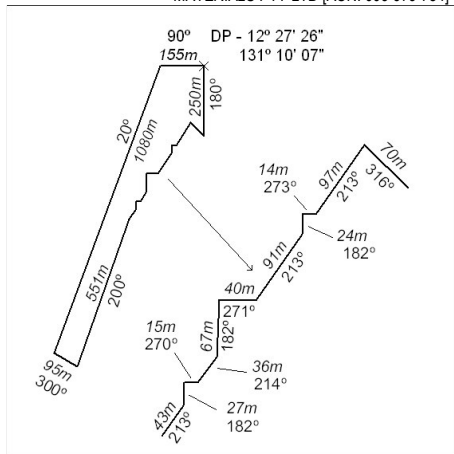

38/09

Mining Act

NOTICE OF GRANT OF A MINING TENEMENT

Title Type and Number: Extractive Mineral Permit 26895
 Granted: 16 January 2009, for a period of 2 Years
 Area: 36.11 Hectares
 Locality: NOONAMAH
 Name of Holder/s: 100% PAGE Dale Nevette

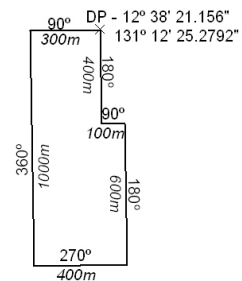

40/09



MN05/09

DARWIN

04 February 2009

Mining Act

NOTICE OF GRANT OF A MINING TENEMENT

Title Type and Number: Extractive Mineral Permit 26896
 Granted: 16 January 2009, for a period of 2 Years
 Area: 12.58 Hectares
 Locality: NOONAMAH
 Name of Holder/s: 100% PAGE Dale Nevette

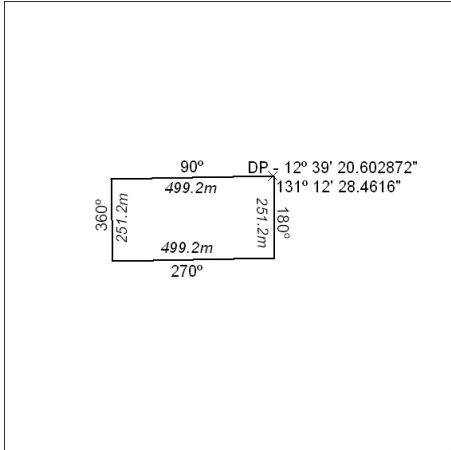

41/09

Mining Act

NOTICE OF GRANT OF AN EXPLORATION LICENCE

Title Type and Number: Substitution Exploration Licence 26825
 Granted: 27 January 2009, for a period of 4 Years
 Area: 424 Blocks, 1280.00 sq kms
 Locality: CRAWFORD
 Name of Holder/s: 100% NEWMONT TANAMI PTY LTD [ACN. 007 688 093]

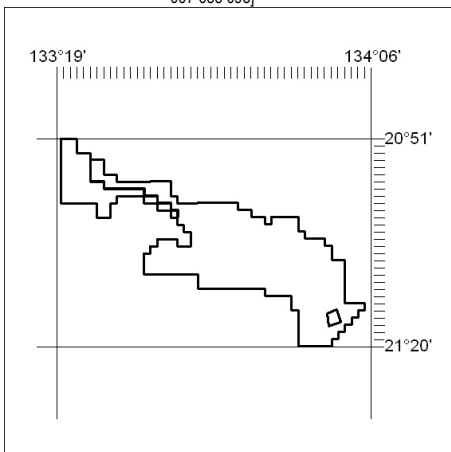

Area granted depicted above. Excluding therefrom all land that is subject of a mining tenement, or an application for a mining tenement made before the application for the grant of this licence, and excluding all land the subject of a reservation from occupation under the *Mining Act* and all land vested in the Commonwealth of Australia.

42/09